

## OPTIMUS CRUX LITE - extremely lightweight-gas canister stove

### PRODUCT CHARACTERISTICS

Fuel:	Gas
ø Burning time:	Up to 60 minutes at full output (230 g gas cartridge)
ø Cooking time:	For 1 l water approx. 3 minutes
Output:	Watt: 3000 BTU: 10'200
Weight:	72 g
Dimensions:	7.5 x ø 5,7 cm
Guarantee:	2 years
Material:	Stainless steel, aluminum
Accessories:	stuff bag
Article No.:	8016272 Optimus Crux Lite



### PRODUCT CHARACTERISTICS > BENEFITS

- With a mere 72 g, one of the lightest stoves in the world
- Powerful and stable 3000 W burner for efficient cooking
- Large burner head for optimal heat distribution
- Precise flame control – simmering without burning
- CE certified: CE-048BN-0045

### OPTIMUS CRUX LITE - extremely lightweight-gas canister stove

#### EXPLODED VIEW

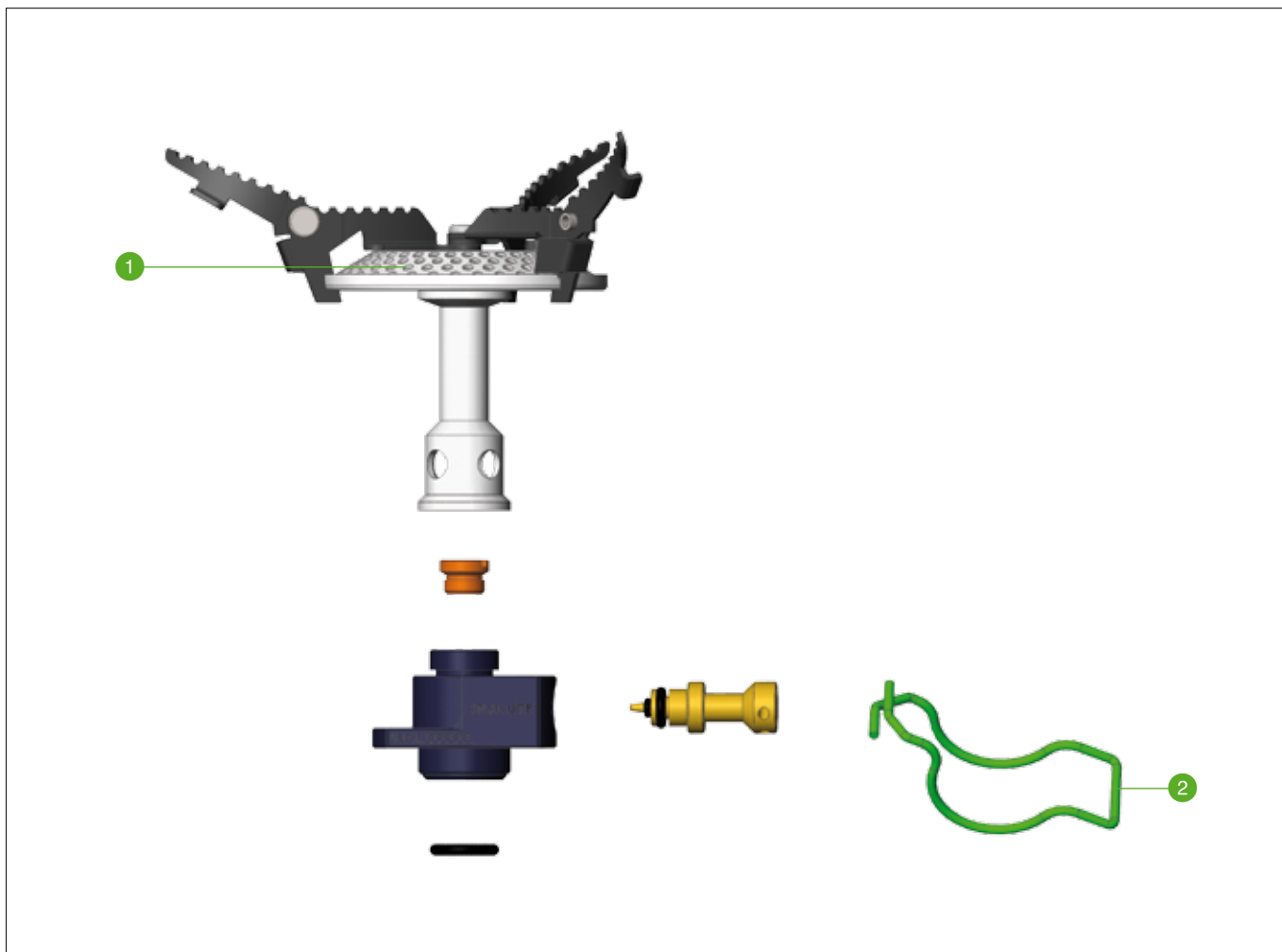

- 1 Burner head
- 2 Control handle

Katadyn reserves the right to modify product characteristics